

# Signode SCM-12/58/34 Manual Combination Tool

## ADJUSTMENTS

### CUTTER

The cutter may have to be adjusted if the tool has been altered to accept a different width or thickness of strap or an adjustment may be needed if the cutter has been replaced due to wear or damage.

Run a cycle with strap of the size to be used. A properly adjusted cutter will sever the top strap completely but the lower strap will have minimal impression, at the most. Excessive scoring of the lower strap is an indication of over cutting and this is not acceptable.

Lay the tool with the strap loading side down, remove the socket head cap screw (SHCS) that attaches the locking plate to the base (it is not necessary to remove the locking plate). Insert a 5.0 mm hex wrench into the end of the eccentric shaft. Rotate the shaft clockwise a few degrees for thinner strap or counterclockwise for heavier strap. There are two mounting holes available for the locking plate. Align the "nearest" hole in the plate to the mounting hole in the base and reinstall the socket head cap screw.

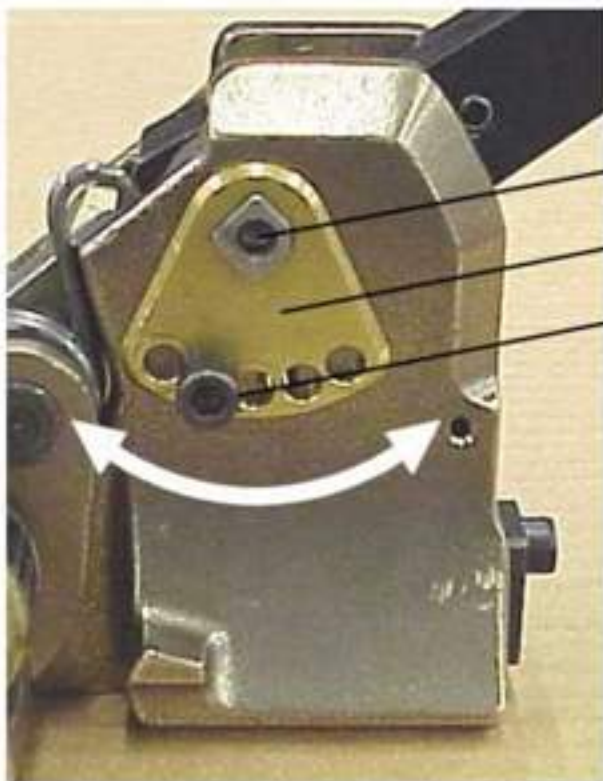

ECCENTRIC SHAFT  
LOCKING PLATE  
SHCS

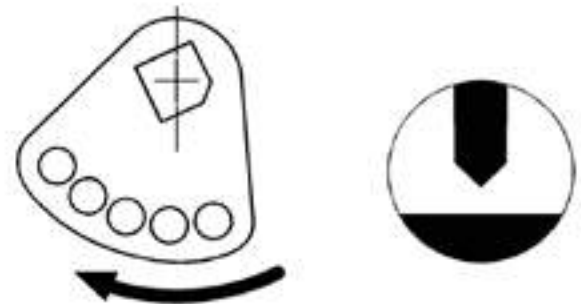

ROTATE THE LOCKING PLATE  
CLOCKWISE TO LOWER THE CUTTER  
FOR THINNER GAUGE STRAPPING.

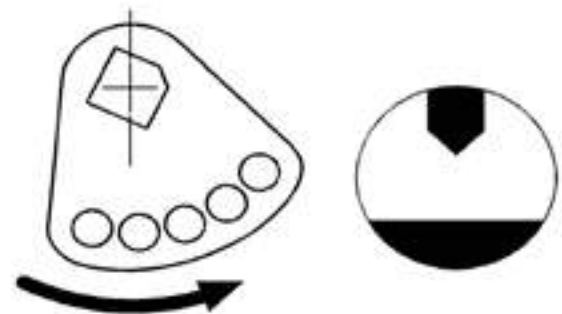

ROTATE THE LOCKING PLATE  
COUNTERCLOCKWISE TO RAISE THE  
CUTTER FOR HEAVIER GAUGE  
STRAPPING.

### FEEDWHEEL AND CLUTCH PLUG

There is no adjustment for feedwheel/clutch plug clearance. The clearance should be .001" to .010" (0.025 to 0.25mm). The most important issue is that the feedwheel does not interfere with the clutch plug.

[www.completepackagingproducts.com](http://www.completepackagingproducts.com)  
TollFree: 866-787-2790



## PARTS LIST

<u>KEY</u>	<u>QTY.</u>	<u>PART NO.</u>	<u>DESCRIPTION</u>
1	1	424091	Base
2	1	424245	Back guide
3	1	424244	Front guide
4	3	010032	SHCS M6x12
5	8	010077	Lock washer M6
6	3	006045	Roll pin 1/8 x 3/8 long
7	2	424098	Lifter
8	1	424106	Locking plate
9	1	185778	SHSS M6x12
10	1	424241	Energizing spring
11	8	274931	Dowel pin 3 x 12 long
12	2	259935	SHCS M3 x 12
13	4	162568	Lock washer M3
14	3	424300	Punch
15	2	262456	SHCS M3 x 6
16	2	162383	SHCS M4 x 8
17	1	424099	Die support
18	1	424094	Cutter
19	1	424107	Cutter anvil
20	1	426937	Die holder
21	1	426939	Cam roller pin
22	2	424117	Washer
23	1	426938	Cam roller
24	49	426936	Needle roller
25	1	424103	Sealer cover
26	1	424121	Outer guide
27	1	162391	Dowel pin 5x24
28	5	010037	SHCS M6x20
29	1	274047	Dowel pin 6 x 16
31	1	424308	<u>Garlock DU bushing 08DU08 1/2 x 1/2</u>
33	1	253433	Dowel pin 4x14
34	1	424120	Link
35	1	425403	Clutch plug
36	1	002678	O-Ring
37	1	424240	Feedwheel
38	1	424309	Feedwheel spacer
40	1	424083	Feedwheel support
42	1	424247	Holding pawl pin
43	1	424249	Pivot pin
44	1	424307	<u>Garlock DU bushing 06DU04 3/8 x 1/4</u>
45	1	003454	Long retaining pawl
46	1	003455	Short retaining pawl
47	2	003483	Retaining pawl spring
48A	1	183295	Klipring, Truarc 5304-31 (Newer Style)
48B	1	005054	Retaining ring, Truarc 5100-31 (Older Style)
49	1	424317	Tension handle assembly
50	1	003462	Handel pawl
51	1	424246	Handle pawl pin
52	1	003467	Pawl spring
53	1	424108	Ratchet

[www.completepackagingproducts.com](http://www.completepackagingproducts.com)

TollFree: 866-787-2790



<u>KEY</u>	<u>QTY.</u>	<u>PART NO.</u>	<u>DESCRIPTION</u>
54	1	426942	Cam/Handle assy (Note-3)
55	1	010054	Knob (Note-3)
56	1	010057	Roll pin 1/4 x 1/ 3/4 (Note-3)
57	2	424303	Cam spacer (Note-3)
58	2	422831	Dowel pin, 4 x 10 (Note-3)
59	1	424079	Eccentric shaft
60	1	274385	Dowel pin 6 x 20
61	1	252247	Dowel pin 5 x 20
65	1	424311	Warning sign
66	1	424312	Nameplate, 1/2
	1	424314	Nameplate, 5/8
	1	424316	Nameplate, 3/4
67	1	286374	Safety sign
68	1	424321	Deflector (Note-6)
69	1	424449	Washer
70	1	086190	Klipring, Truarc 5304-37
80	1	425410	Feedwheel cover sub-assembly
81	1	425375	Outer bearing
82	1	425401	Feedwheel shaft

- When ordering parts, please show model, part number and description.
- Standard hardware parts may be obtained at any local hardware supply.
- Recommended spare parts are underlined and should be stocked.

#### NOTES:

1. Locking Plate (Key 8) must be installed with the text "OUT" facing away from base.
2. Outer Guide (Key 26) must be installed with chamfer side out.
3. Key numbers 54 through 58 and Key 24 can be purchased as Part No. 426943.
4. Socket head cap screws (Key 28) which secure the Sealer Cover (Key 25) must be torqued to 85-95 in-lbs.
5. Lubricate all moving parts with Molith No. 2 or Lubriplate 3000W Grease (Signode Part No. 422793).
6. The Deflector (Key 68) is an optional part which is used to prevent the strap from curling around the feedwheel from severe high tension applications.
7. Key numbers 31, 33, 60, 80 and 81 can be purchased together as Signode Part No. 425408.
8. Key numbers 6, 35, and 36 can be purchased together as Signode Part No. 425405.
9. Key numbers 20, 21, 22, 23 & 24 can be purchased together as Signode Part No. 426944.

### **⚠ WARNING**

Inspect all parts daily and replace them if they are worn or broken. Failure to do this can affect a product's operation and could result in serious personal injury.

[www.completepackagingproducts.com](http://www.completepackagingproducts.com)  
TollFree: 866-787-2790



\* Use Loctite #242 (Signode Part No. 422795) or equivalent.

\*\* Use Loctite #222 (Signode Part No. 422794) or equivalent.

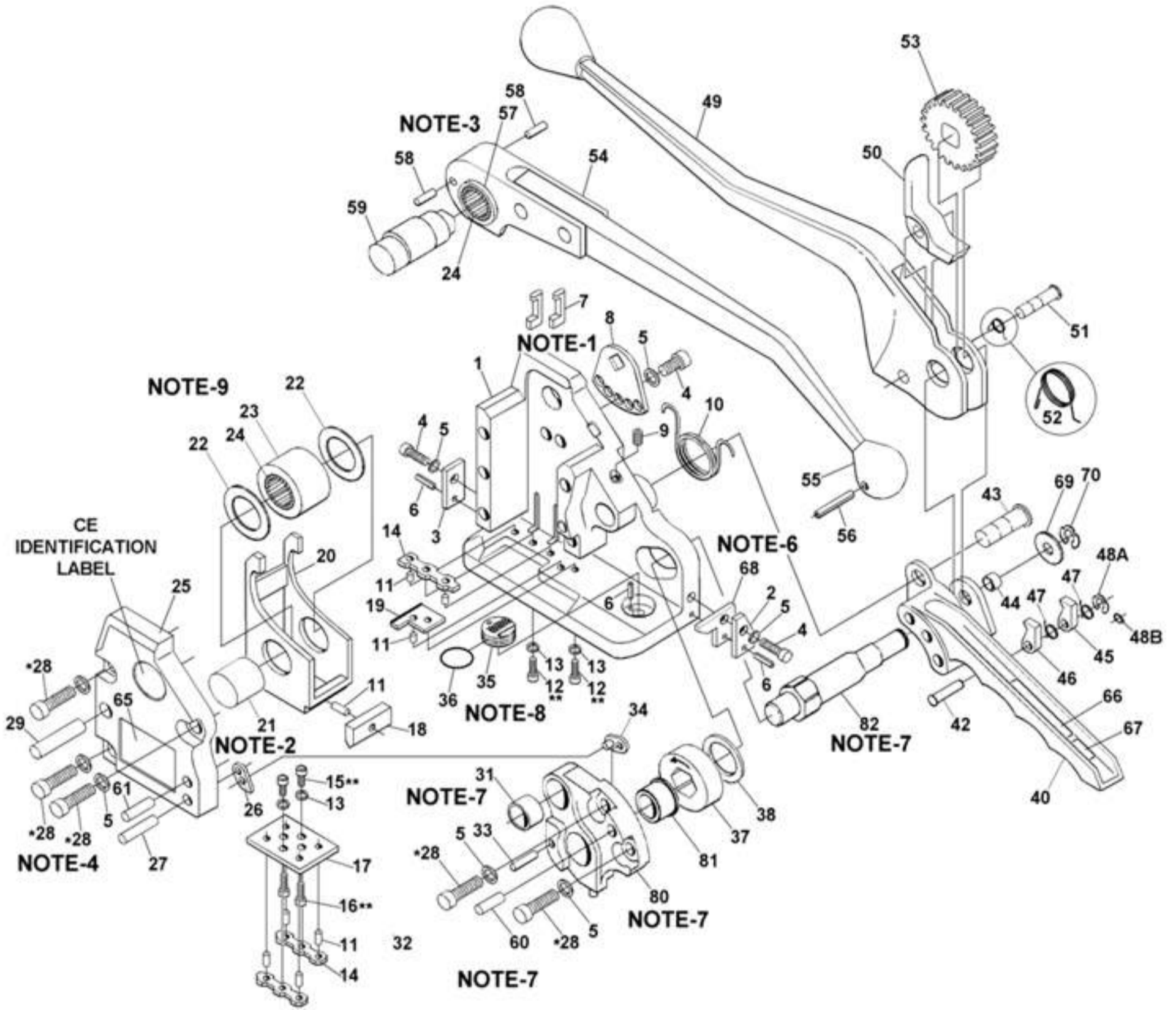

Review page 11 of this manual for explanation of notes.

[www.completepackagingproducts.com](http://www.completepackagingproducts.com)  
TollFree: 866-787-2790



## TROUBLESHOOTING

The following items are the most common tool symptoms if problems should occur. For symptoms or remedies not shown, contact your Signode service representative for additional information and details. The following tool symptoms are shown in this manual:

#1 SYMPTOM: Difficult strap slack removal.

#2 SYMPTOM: Poor tensioning

#3 SYMPTOM: Joint fails after tool is removed or joint not made properly.

#4 SYMPTOM: Excessive effort needed to seal straps together.

#5 SYMPTOM: Tool will cut-off strap after sealing , or bottom strap cut too deep.

#6 SYMPTOM: Tool cannot be removed from strap after cycle is completed.

#7 SYMPTOM: Feedwheel slips during tensioning.

#1 SYMPTOM: Difficult strap slack removal.	
CAUSE	REMEDY
1. Strap not lubricated or not waxed adequately.	1. Purchase only lubricated (waxed) strapping.
2. Strap not inserted properly (strap caught by outer guide)	2. Insert and align straps in tool properly.
3. Damaged parts in tension sub-assembly.	3. Inspect the tension assembly's ratchet wheel and pawls for damage or broken parts.

#2 SYMPTOM: Poor tensioning.	
CAUSE	REMEDY
1. Feedwheel or clutch plug packed with dirt or grit.	1. If top strap is slipping, clean dirt from the feedwheel or replace worn feedwheel if necessary.
2. Feedwheel or clutch plug teeth are worn.	2. If bottom strap is slipping, clean dirt from the clutch plug or replace worn clutch plug if necessary.
3. Strap not properly aligned when inserted into tool.	3. Insert strap into tool carefully aligning strap.

**NOTE:** Carefully inspect strap applied to determine if top or bottom strap is slipping.

[www.completepackagingproducts.com](http://www.completepackagingproducts.com)

TollFree: 866-787-2790



## TROUBLESHOOTING, Continued

<b>#3 SYMPTOM: Joint fails after tool is removed or joint does not appear to have been made properly.</b>	
<b>CAUSE</b>	<b>REMEDY</b>
1. Low joint strength caused by chipped or worn sealer parts.	1. Inspect sealing parts for wear or chipped edges.
2. Strap not strong enough to contain load or force exerted by load.	2. Review application to determine proper strapping to use. If necessary contact your Signode sales representative.
3. Joint made on strap that had not been tensioned to a proper level.	3. Make sure that tension is applied to the straps before the sealer handle is operated.
4. Strap not inserted properly- 3 punches must penetrate both straps.	4. Insert straps with bottom strap extending 1" to 1 1/2" (25-40mm) past the front of the tool.
5. Bottom strap being cut by the cutter.	5. Adjust cutter as required.

<b>#4 SYMPTOM: Excessive effort needed to seal straps together.</b>	
<b>CAUSE</b>	<b>REMEDY</b>
1. Broken needles within the sealer handle assembly.	1. Carefully inspect sealer drive for worn or broken parts.
2. Worn dies, punch or cutter.	2. Replace appropriate dies, punch or cutter.
3. Poor tool lubrication.	3. Lubricate eccentric shaft, bearing needles, sealer cam and cam roller.

<b>#5 SYMPTOM: Tool will not cut-off strap after sealing (cannot remove tool) or bottom strap cut too deeply.</b>	
<b>CAUSE</b>	<b>REMEDY</b>
1. Cutter blade damaged or worn. Cut strap manually from package too release tension and de-energize feedwheel.	1. Inspect cutter for wear or damage, replace as necessary.
2. Different gauge (thinner) strap requires cutter adjustment.	2. Adjust cutter blade for gauge of strap being used.

[www.completepackagingproducts.com](http://www.completepackagingproducts.com)  
TollFree: 866-787-2790



<b>#6 SYMPTOM: Tool cannot be removed from strap after cycle is completed.</b>	
<b>CAUSE</b>	<b>REMEDY</b>
1. Upper strap was not cut off.	1. Inspect both the cutter for damage or adjustment. Cut strap manually from package to release tension and de-energize feedwheel.
2. Chipped or worn parts (punches and dies).	2. Inspect and replace worn sealer parts.

<b>#7 SYMPTOM: Feedwheel slips during tensioning.</b>	
<b>CAUSE</b>	<b>REMEDY</b>
Flat spot on feedwheel.	Replace feedwheel.

[www.completepackagingproducts.com](http://www.completepackagingproducts.com)  
TollFree: 866-787-2790



## CHANGING SCM STRAP SIZE

The following table illustrates the unique parts to a particular strap size for the SCM tool. If the strap size of the tool is to be changed, this table must be used to coordinate all the respective parts which must be reconfigured or replaced.

Follow all specified parts removal, replacement & adjustment procedures found in this manual when changing any of the strap conversion parts.

### **! WARNING**

Do not attempt to convert a tool's strap size without replacing/reconfiguring all of the specified parts for the conversion. Failure to replace/reconfigure all required parts may cause severe personal injury.

#### UNIQUE PARTS & CONFIGURATION TO SCM STRAP SIZES

KEY	QTY	DESCRIPTION	1/2" (12mm)	5/8" (16mm)	3/4" (19mm)
3	1	Front Guide	424244, Note-1	424244, Note-2	424244, Note-2
2	1	Back Guide	424245, Note-3	424245, Note-4	424245, Note-4
26	1	Outer Guide	424121, Note-5	424121, Note-5	424121, Note-6
63	1	Nameplate	424312	424314	424316



BACK GUIDE

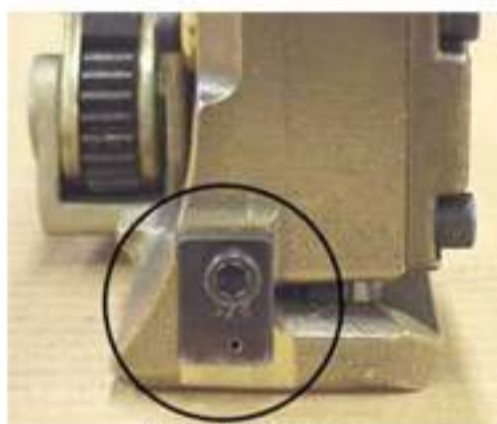

FRONT GUIDE

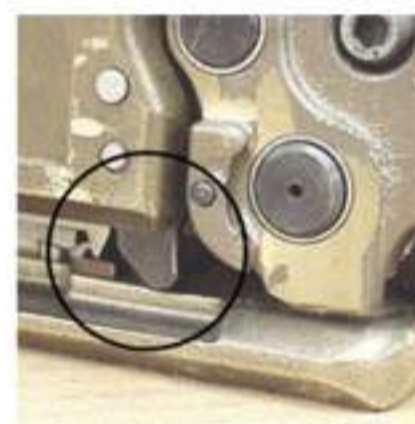

OUTER GUIDE

#### NOTES:

1. Install guide (Key 3) with text "1/2" facing outward from tool.

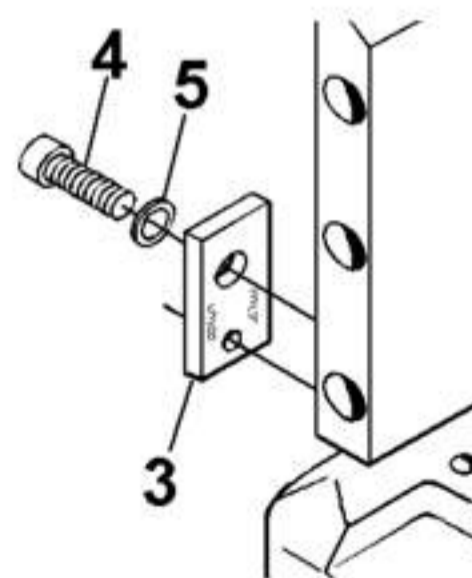

[www.completepackagingproducts.com](http://www.completepackagingproducts.com)

TollFree: 866-787-2790





2. Install guide (Key 3) with text "5/8 3/4" facing outward from tool.

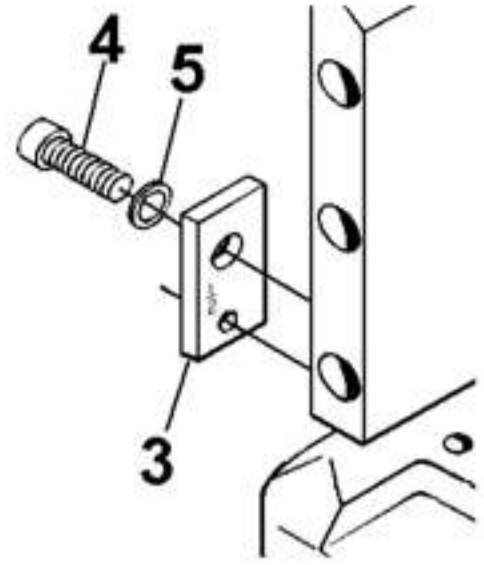

3. Install guide (Key 2) with text "1/2" facing outward from tool.

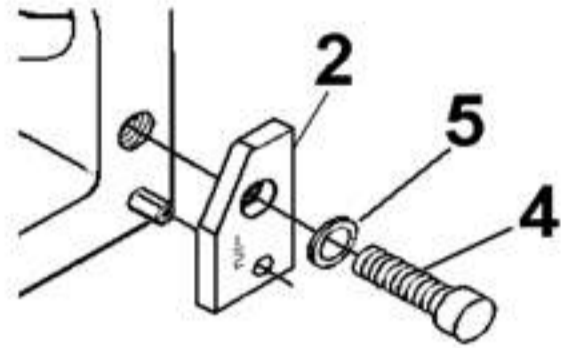

4. Install guide (Key 2) with text "5/8 3/4" facing outward from tool.

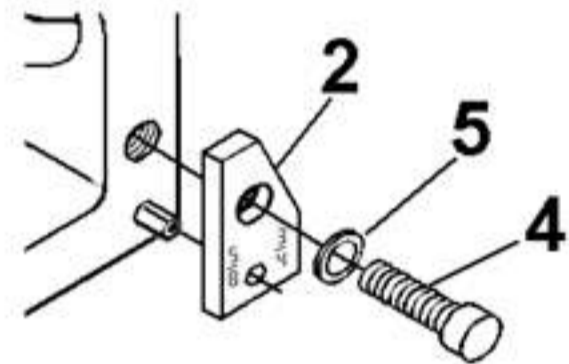

5. Install the guide (Key 26) in the inward position. Install the link (Key 34) in the outer position with the stem facing inwards.

*NOTE: Always install guide (Key 26) with the chamfer facing out.*

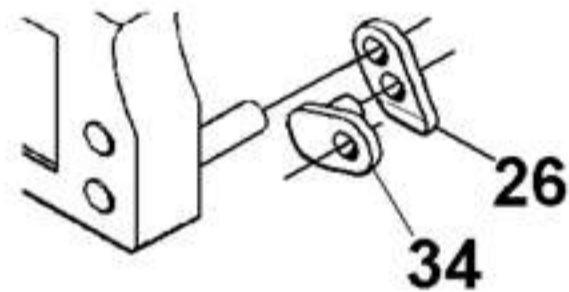

6. Install the guide (Key 26) in the outer position. Install the link (Key 34) in the inner position with the stem facing outwards.

*NOTE: Always install guide (Key 26) with the chamfer facing out.*

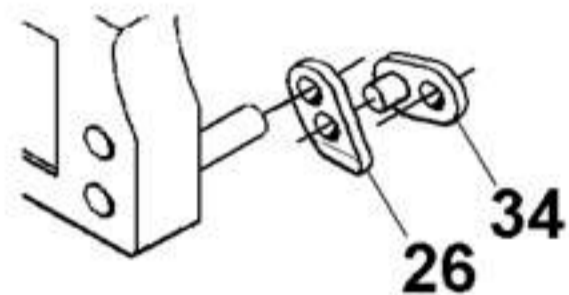

## TOOL OPTIONS

### STRAP DEFLECTOR (Part No. 424321)

The strap deflector (Key 68) is an optional part which is used to prevent the strap from curling around the feedwheel from severe high tension applications. The deflector is installed on the tool behind the back guide (Key 2) as shown using the existing hardware.



THE STRAP DEFLECTOR IS INSTALLED BEHIND THE BACK GUIDE.

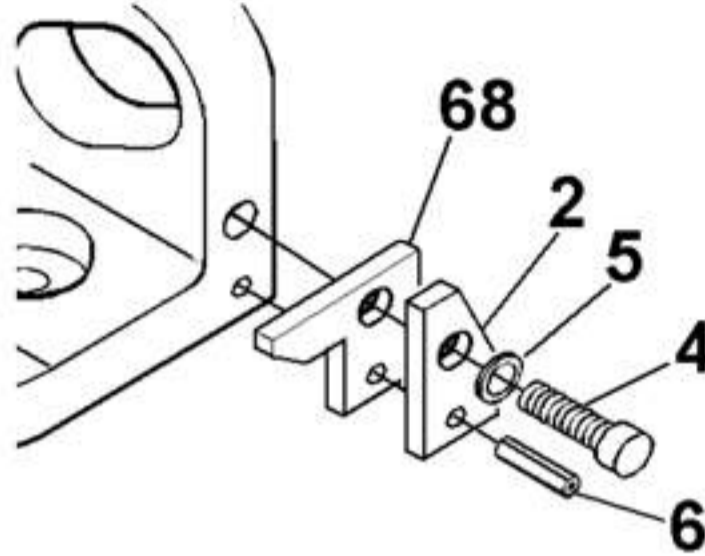

INSTALL THE DEFLECTOR USING THE EXISTING MOUNTING HARDWARE.

[www.completepackagingproducts.com](http://www.completepackagingproducts.com)  
TollFree: 866-787-2790

